

8581 Morrison Creek Drive

Sacramento, CA | Morrison Creek Business Park

±4,800 SF Available with ±640 SF of Office



Contact Us

Zac Sweet, SIOR
Senior Vice President
C: 916 717 4768
zac.sweet@cbre.com
Lic. 01352800

Courtney Lee
Associate
C: 916 906 5544
courtney.lee@cbre.com
Lic. 02031694

Tyler Howell
Senior Associate
+1 916 781 4835
tyler.howell1@cbre.com
Lic. 02100245



Property Information

**8581 Morrison Creek Drive
Sacramento, CA 95828**

- + AVAILABLE SF: $\pm 4,800$ SF
- + OFFICE SF: ± 640 SF
- + ZONING: M-2S HEAVY INDUSTRIAL
- + CLEAR HEIGHT: 18'-20'
- + GRADE LEVEL DOORS: 4 - 12'X14'
- + ELECTRICAL: 200A/120 - 480V*

**Tenant to independently verify prior to entering binding agreement*

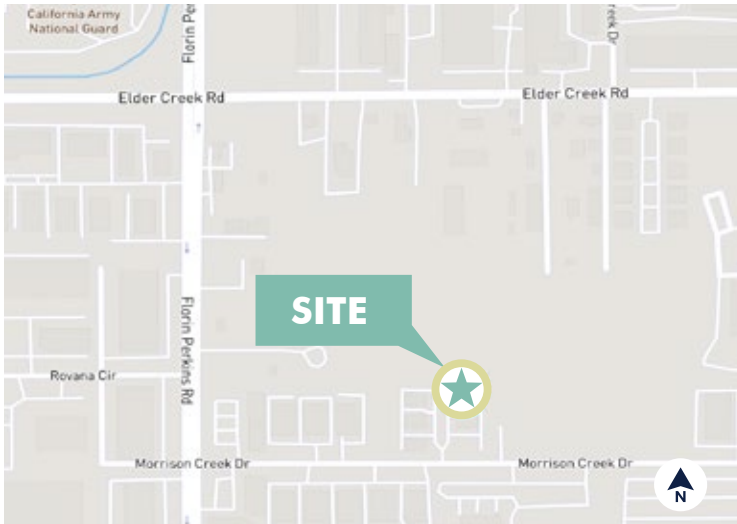

Contact Us

Zac Sweet, SIOR
Senior Vice President
C: 916 717 4768
zac.sweet@cbre.com
Lic. 01352800

Courtney Lee
Associate
C: 916 906 5544
courtney.lee@cbre.com
Lic. 02031694

Tyler Howell
Senior Associate
+1 916 781 4835
tyler.howell1@cbre.com
Lic. 02100245



Site Plan

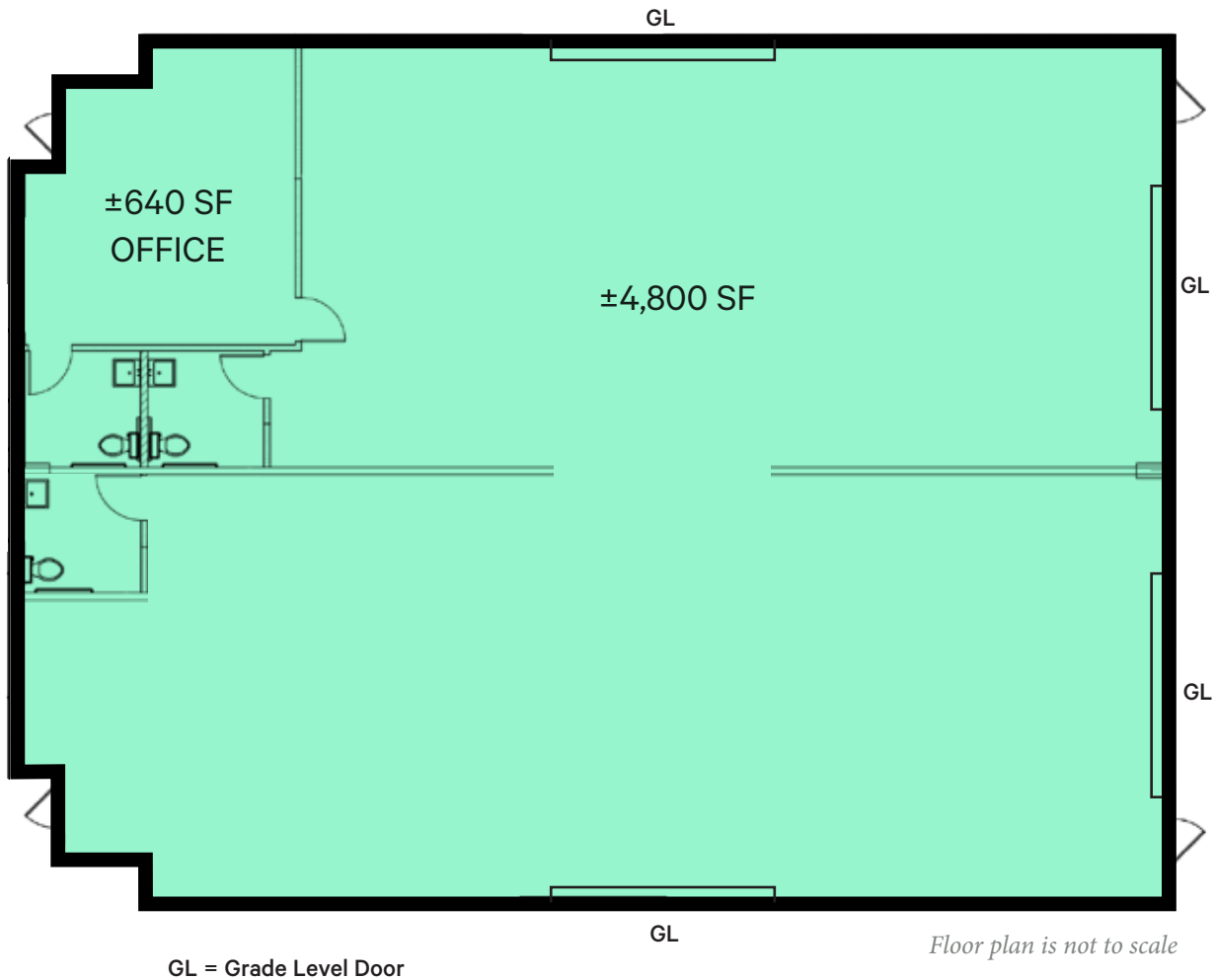

Contact Us

Zac Sweet, SIOR
Senior Vice President
C: 916 717 4768
zac.sweet@cbre.com
Lic. 01352800

Courtney Lee
Associate
C: 916 906 5544
courtney.lee@cbre.com
Lic. 02031694

Tyler Howell
Senior Associate
+1 916 781 4835
tyler.howell1@cbre.com
Lic. 02100245

